

Visual and Sound Scavenger Hunts at Mer Bleue, Dolman-Ridge Road

Winter version

Park at lot **P23** on Dolman-Ridge Road, 1 km from Anderson Road. The road continues east for 2.6 km. You will have to backtrack to your car. There are bird feeders at the parking lot that are filled in winter. This is also the start of the Dewberry Trail, **which does not permit dogs. Dogs are permitted on Dolman-Ridge Road. NCC patrols the Dewberry Trail!** For other quests go to our website: ofnc.ca/quests

Sound Hunt (listen for these)

- Downy/Hairy Woodpecker
- Pileated Woodpecker
- Blue Jay
- White-breasted Nuthatch
- Black-capped Chickadee
- Drumming of any type of woodpecker
- Crow or Raven
- American Goldfinch
- Mourning Dove
- Red Squirrel

Score: ____ of 10

Other wildlife seen or heard:

Dolman-Ridge Road (in red) trail

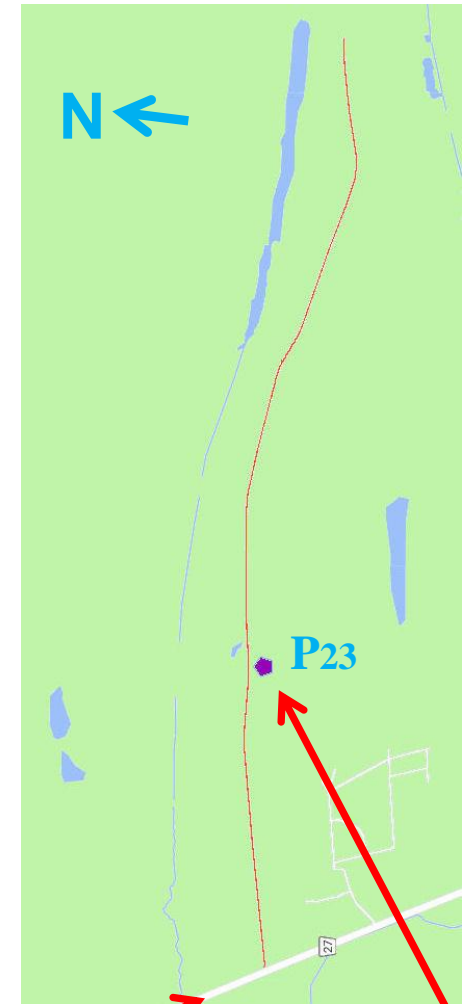

Anderson Road
Park and start here.



Ottawa Field-Naturalists' Club
Club des naturalistes d'Ottawa